



# SHRINK FIT HOLDER

## SFHS

### SHRINK FIT HOLDER (EXTRA SLIM)

DIN 69893/  
ISO 12164-1-HSK FORM A

SCHRUMPFUTTER  
MANDRIN DE FRETTAGE  
MADRINI PER CALLETAMENTO A CALDO  
PORTAHERRAMIENTAS DE COMPRESION POR CALOR

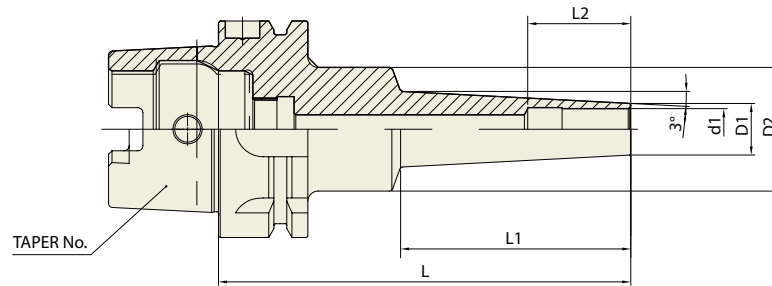

Unit : mm

TAPER No.	MODEL No.	EDP No.	d1	D1	D2	L	L1	L2	WEIGHT (kg)
40A	HSK40A-SFHS3-60	P2779801S	3	6	20	60	22	9	-
	HSK40A-SFHS3-90	P2779802S	3	6	20	80	42	9	-
	HSK40A-SFHS4-60	P2779803S	4	7	20	60	22	12	-
	HSK40A-SFHS4-90	P2779804S	4	7	20	80	42	12	-
	HSK40A-SFHS6-60	P2779805S	6	9	20	60	22	18	-
	HSK40A-SFHS6-90	P2779806S	6	9	20	80	42	18	-
50A	HSK50A-SFHS3-95	P2779807S	3	6	26	95	42	9	-
	HSK50A-SFHS3-120	P2779808S	3	6	26	120	67	9	-
	HSK50A-SFHS4-95	P2779809S	4	7	26	95	42	12	-
	HSK50A-SFHS4-120	P2779810S	4	7	26	120	67	12	-
	HSK50A-SFHS6-95	P2779811S	6	9	26	95	42	18	-
	HSK50A-SFHS6-120	P2779812S	6	9	26	120	67	18	-
	HSK50A-SFHS8-95	P2779813S	8	11	36	95	42	24	-
	HSK50A-SFHS8-120	P2779814S	8	11	36	120	67	24	-
	HSK50A-SFHS10-95	P2779815S	10	13	36	95	42	30	-
	HSK50A-SFHS10-120	P2779816S	10	13	36	120	67	30	-
63A	HSK63A-SFHS3-95	P2779817S	3	6	26	95	42	9	0.75
	HSK63A-SFHS3-120	P2779818S	3	6	26	120	67	9	0.77
	HSK63A-SFHS4-95	P2779819S	4	7	26	95	42	12	0.75
	HSK63A-SFHS4-120	P2779820S	4	7	26	120	67	12	0.78
	HSK63A-SFHS6-95	P2779821S	6	9	26	95	42	18	0.76
	HSK63A-SFHS6-120	P2779822S	6	9	26	120	97	18	0.78
	HSK63A-SFHS8-95	P2779823S	8	11	36	95	42	24	0.75
	HSK63A-SFHS8-160	P2779824S	8	11	36	160	97	24	0.97
	HSK63A-SFHS10-95	P2779825S	10	13	36	95	42	30	0.76
	HSK63A-SFHS10-160	P2779826S	10	13	36	160	97	30	1.00
	HSK63A-SFHS12-95	P2779827S	12	15	36	95	42	30	0.83
	HSK63A-SFHS12-160	P2779828S	12	15	36	160	97	30	1.04
100A	HSK100A-SFHS3-95	P2779829S	3	6	26	95	42	9	2.12
	HSK100A-SFHS3-120	P2779830S	3	6	26	120	67	9	2.14
	HSK100A-SFHS4-95	P2779831S	4	7	26	95	42	12	2.12
	HSK100A-SFHS4-120	P2779832S	4	7	26	120	67	12	2.14
	HSK100A-SFHS6-95	P2779833S	6	9	26	95	42	18	2.12
	HSK100A-SFHS6-120	P2779834S	6	9	26	120	67	18	2.15
	HSK100A-SFHS8-95	P2779835S	8	11	36	95	42	24	2.18
	HSK100A-SFHS8-160	P2779836S	8	11	36	160	97	24	2.33
	HSK100A-SFHS10-95	P2779837S	10	13	36	95	42	30	2.19
	HSK100A-SFHS10-160	P2779838S	10	13	36	160	97	30	2.34
	HSK100A-SFHS12-95	P2779839S	12	15	36	95	42	30	2.20
	HSK100A-SFHS12-160	P2779840S	12	15	36	160	97	30	2.38

► CAT(ANSI B5.50) taper and Inch type products are available.

## SHRINK FIT HOLDER

### High Precision I.D Run-out : $\leq 0.003\text{mm}$

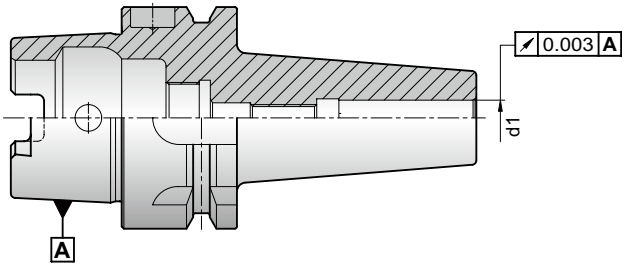

- Less than 0.003mm of Tool Holder accuracy at I.D

### Strong and Consistent Torque Power

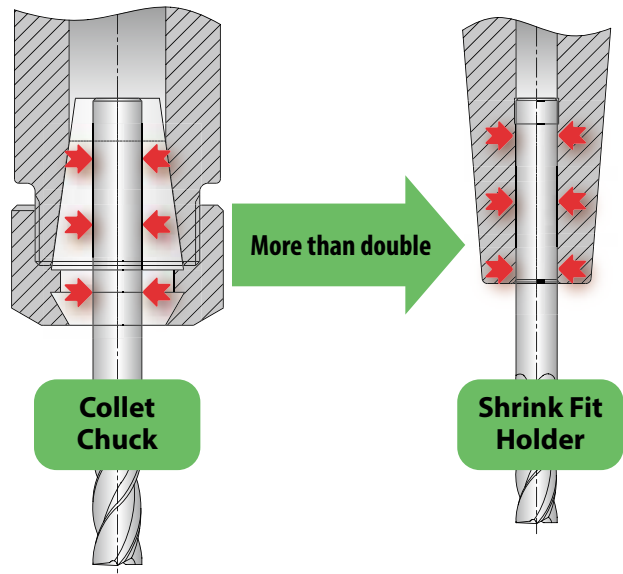

- Achieving strong torque power by integration of chuck and tool

### Deep hole Machining

Collet Chuck

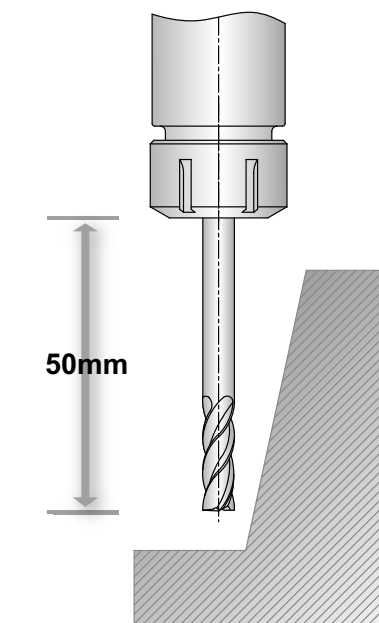

Shrink Fit Holder

More favorable in deep hole machining

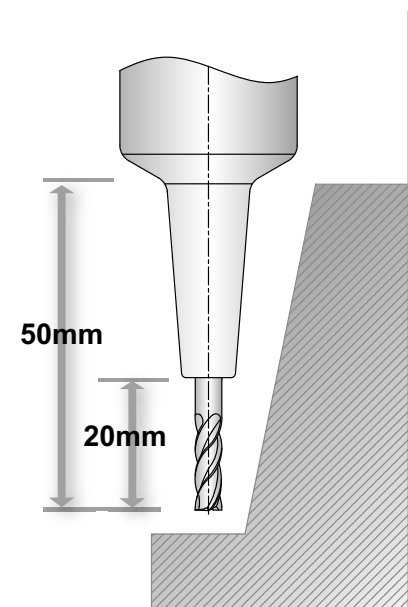

- Suitable for High-Speed precision deep hole machining

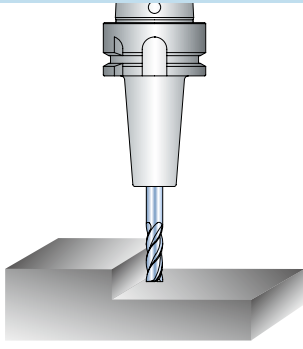
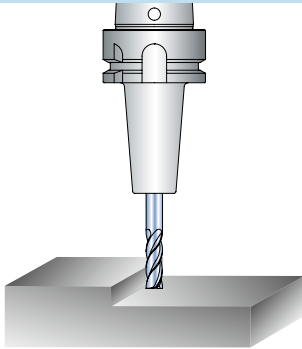
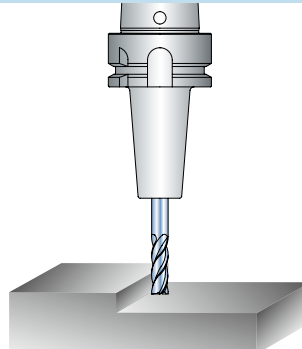
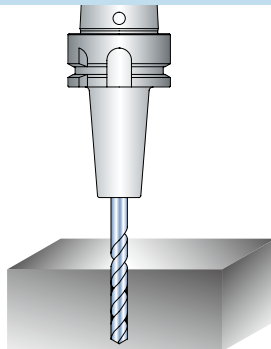
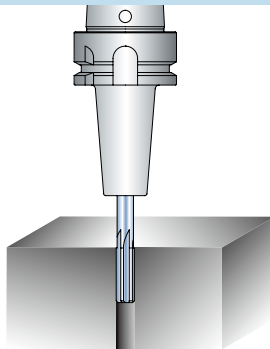
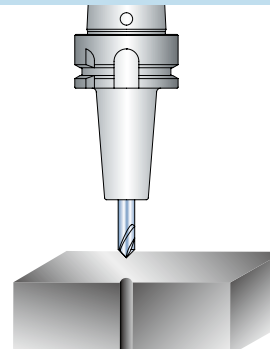
APPLICATION		
<b>Rough Milling</b> 	<b>Finish Milling</b> 	<b>High-Speed Cutting</b> 
<b>Drilling</b> 	<b>Reaming</b> 	<b>Countersinking</b> 

### Shank Type of Cutting Tool

Straight shank



One weldon flat shaft type



• One Weldon flat shaft type tool is usable, but there is a possibility that the I.D of shrink fit holder may be deformed.

### Material of Cutting Tool

CARBIDE  
TOOL

HSS  
TOOL

OK

NO



**TECHNICAL DATA : SHANK STANDARD**

**DIN 69893/  
ISO12164-1-HSK**

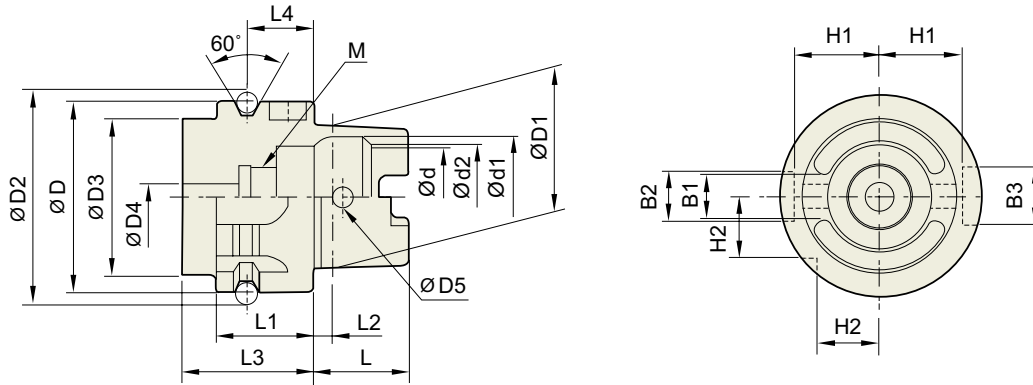

Unit : mm

TAPER No.	$\varnothing D$	$\varnothing D1$	$\varnothing D2$	$\varnothing D3$	$\varnothing D4$	$\varnothing D5$	L	L1	L2	L3	L4
HSK32A	32	24	37.00	26	4.2	4.0	16	20	3.2	35	16
HSK40A	40	30	45.00	34	5.0	4.6	20	20	4.0	35	16
HSK50A	50	38	59.30	42	6.8	6.0	25	26	5.0	42	18
HSK63A	63	48	72.30	53	8.4	7.5	32	26	6.3	42	18
HSK80A	80	60	88.8	68	10.2	8.5	40	26	8	42	18
HSK100A	100	75	109.75	85	12.0	12.0	50	29	10.0	45	20

Unit : mm

TAPER No.	$\varnothing d$	$\varnothing d1$	$\varnothing d2$	B1	B2	B3	H1	H2	L4
HSK32A	17	20.5	19	7.05	7	9	13.0	9.5	M10×1.0
HSK40A	21	25.5	23	8.05	9	11	17.0	12.0	M12×1.0
HSK50A	26	32.0	29	10.54	12	14	21.0	15.5	M16×1.0
HSK63A	34	40.0	37	12.54	16	18	26.5	20.0	M18×1.0
HSK80A	42	50	46	16.04	18	20	34	25	M20×1.5
HSK100A	53	63.0	58	20.02	20	22	44.0	31.5	M24×1.5

# MODEL NUMBERING SYSTEM & SURFACE FINISH

## Model Numbering System

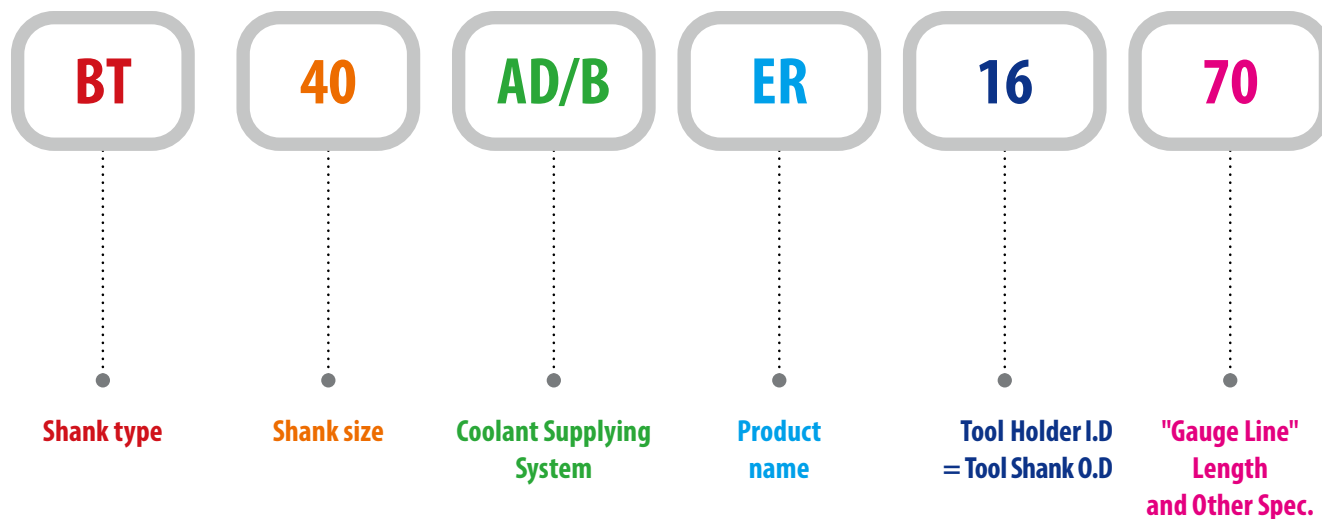

## Surface Finish

