

Drilling - Drill Holder

**X-Drill Holder (SYM08) (DC 24~28)**

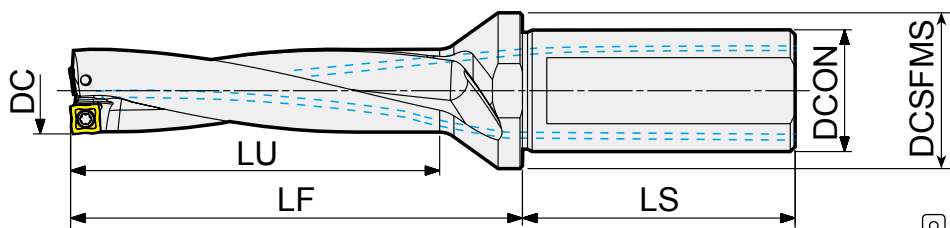

☐: p.200 Unit:mm

Series	DC	LU	Designation	EDP 3700..	LF	OAL	DCON	DCSFMS	LS
24	48		YGSY2 - 240S32 - 08	1025	70	130.0	32	45	60
	72		YGSY3 - 240S32 - 08	1037	94	154.0			
	96		YGSY4 - 240S32 - 08	1049	118	178.0			
	120		YGSY5 - 240S32 - 08	1061	142	202.0			
25	50		YGSY2 - 250S32 - 08	1026	72	132.0			
	75		YGSY3 - 250S32 - 08	1038	97	157.0			
	100		YGSY4 - 250S32 - 08	1050	122	182.0			
	125		YGSY5 - 250S32 - 08	1062	147	207.0			
26	52		YGSY2 - 260S32 - 08	1027	73	133.0			
	78		YGSY3 - 260S32 - 08	1039	99	159.0			
	104		YGSY4 - 260S32 - 08	1051	125	185.0			
	130		YGSY5 - 260S32 - 08	1063	151	211.0			
27	54		YGSY2 - 270S32 - 08	1028	77	137.0			
	81		YGSY3 - 270S32 - 08	1040	104	164.0			
	108		YGSY4 - 270S32 - 08	1052	131	191.0			
	135		YGSY5 - 270S32 - 08	1064	158	218.0			
28	56		YGSY2 - 280S32 - 08	1029	79	139.0			
	84		YGSY3 - 280S32 - 08	1041	107	167.0			
	112		YGSY4 - 280S32 - 08	1053	135	195.0			
	140		YGSY5 - 280S32 - 08	1065	163	223.0			

**NEW**  
**SYM08**  
**080306**

**PLUG (DCON32)**

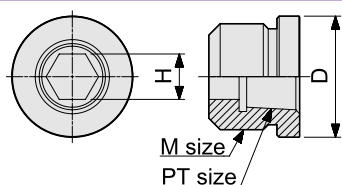

Designation	EDP No.	DCON	ØD	M size	PT size	H
PLUG M22-1/4	38000003	32	24	M22x1.25	PT 1/4	10

\* Plug for turning lathe should be ordered separately.

\* Clamping Torque (Nm) 1.2Nm

SYM08	Screw	Wrench
Description	TP072506-GS	TPWFTP07
EDP	18000261	18000001

Plug	DCON	Ø 20	Ø 25	Ø 32
	Description	PLUG M12-1/8	PLUG M14-1/8	PLUG M22-1/4
	EDP	38000001	38000002	38000003