

X-Drill Holder (SYMX06) (DC 17~20)

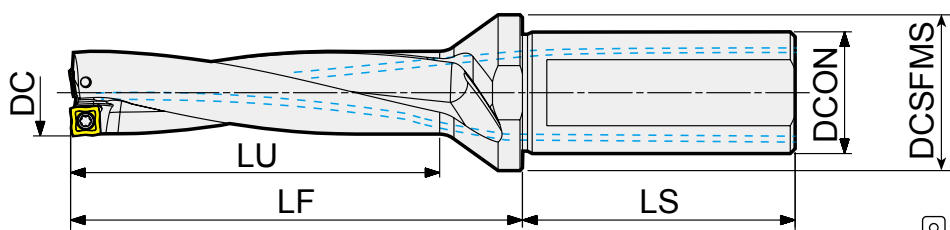

☐: p.200 Unit:mm

Series	DC	LU	Designation	EDP 3700..	LF	OAL	DCON	DCSFMS	LS
17	34		YGSY2 - 170S25 - 06	0851	54	110.0	25	32	56
	51		YGSY3 - 170S25 - 06	0855	71	127.0			
	68		YGSY4 - 170S25 - 06	0859	88	144.0			
	85		YGSY5 - 170S25 - 06	0863	105	161.0			
	36		YGSY2 - 180S25 - 06	0852	57	113.0			
18	54		YGSY3 - 180S25 - 06	0856	75	131.0			
	72		YGSY4 - 180S25 - 06	0860	93	149.0			
	90		YGSY5 - 180S25 - 06	0864	111	167.0			
19	38		YGSY2 - 190S25 - 06	0853	59	115.0			
	57		YGSY3 - 190S25 - 06	0857	78	134.0			
	76		YGSY4 - 190S25 - 06	0861	97	153.0			
20	95		YGSY5 - 190S25 - 06	0865	116	172.0			
	40		YGSY2 - 200S25 - 06	0854	63	119.0			
	60		YGSY3 - 200S25 - 06	0858	83	139.0			
	80		YGSY4 - 200S25 - 06	0862	103	159.0			
	100		YGSY5 - 200S25 - 06	0866	123	179.0			

NEW
SYMX
060204

PLUG (DCON25)

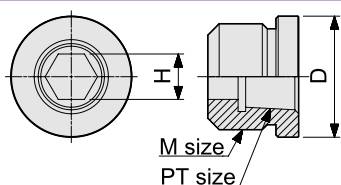

Designation	EDP No.	DCON	ØD	M size	PT size	H
PLUG M14-1/8	38000002	25	16	M14x1.0	PT 1/8	6

* Plug for turning lathe should be ordered separately.

* Clamping Torque (Nm) 0.7Nm

SYMX06	Screw	Wrench
Description	TP072205-GS	TPWFTP07
EDP	18000253	18000001

Plug	DCON	Ø 20	Ø 25	Ø 32
	Description	PLUG M12-1/8	PLUG M14-1/8	PLUG M22-1/4
	EDP	38000001	38000002	38000003